

PLAN NO. 550  
FOR THE IMPROVEMENT OF  
**K STREET**

BETWEEN  
SIXTH STREET AND SEVENTH STREET  
IN THE  
CITY OF SAN BERNARDINO, CALIFORNIA

Scale 1"=40'

C. F. Johnson  
City Engineer

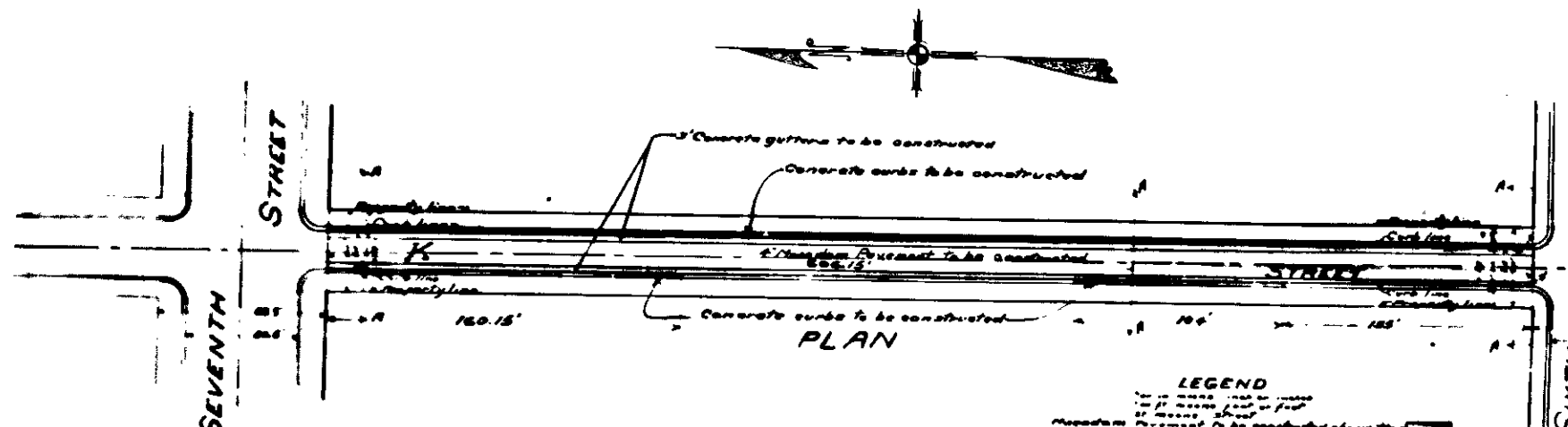

PLAN

**LEGEND**

Proposed Pavement	to be constructed above the existing street
Concrete gutter	to be constructed above the proposed pavement
Concrete curb	to be constructed above the proposed pavement
Center of K Street	to be constructed above the proposed pavement
Center of K Street	to be constructed above the proposed pavement
Center of K Street	to be constructed above the proposed pavement

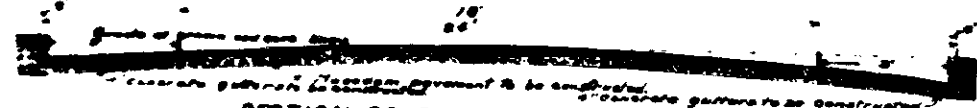

SECTION OF PAVEMENT A-A

Scale 1"=4'

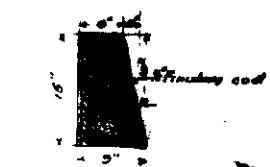

SECTION OF CURB

Scale 1"=1'

All elevations shown in this plan are based on the datum of mean sea level as established by ordinance of 1923 of the City of San Bernardino, California.

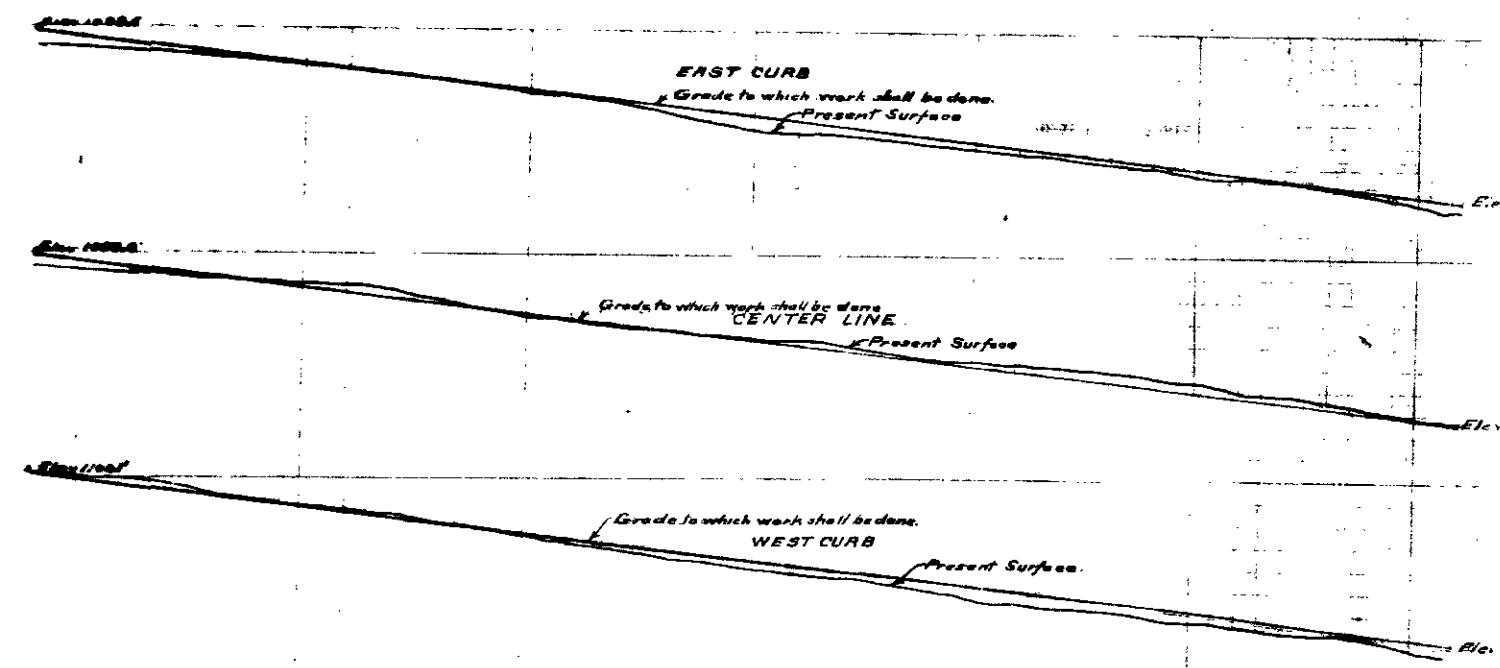

**PROFILE**  
BLACK LINES SHOW PRESENT SURFACE  
RED LINES SHOW GRADE TO WHICH WORK SHALL BE DONE

PLAN NO. 550  
FOR THE IMPROVEMENT OF  
**K STREET**

BETWEEN  
SIXTH STREET AND SEVENTH STREET  
IN THE  
CITY OF SAN BERNARDINO, CALIFORNIA

Scale 1"=40'

C. F. Johnson  
City Engineer

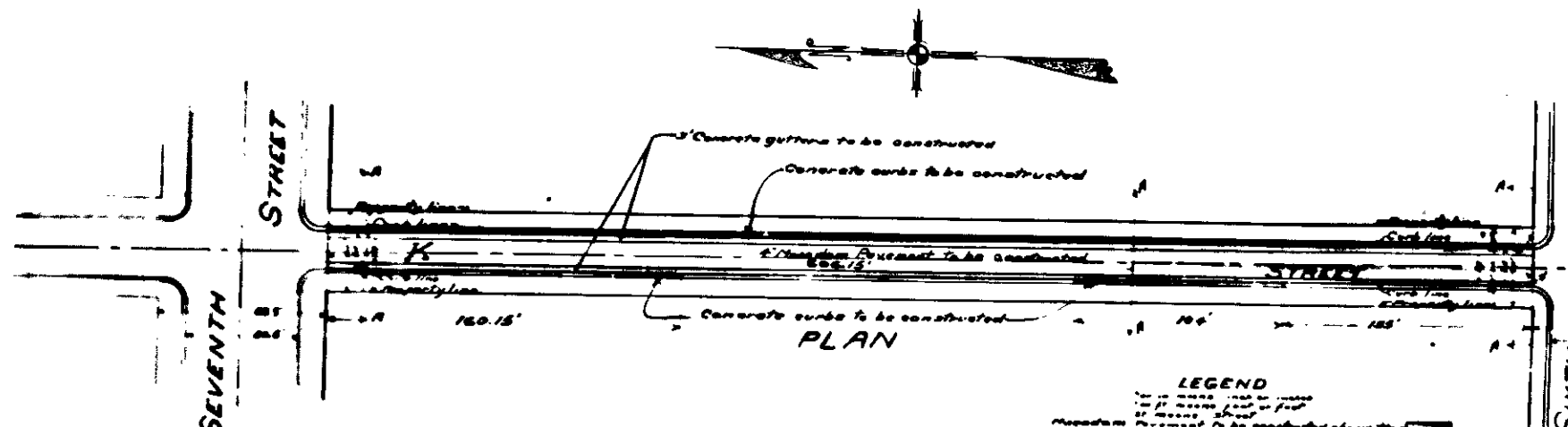

PLAN

**LEGEND**

Proposed Pavement	to be constructed above the existing street
Concrete gutter	to be constructed above the proposed pavement
Concrete curb	to be constructed above the proposed pavement
Center of gutter	to be constructed above the proposed pavement
Center of curb	to be constructed above the proposed pavement

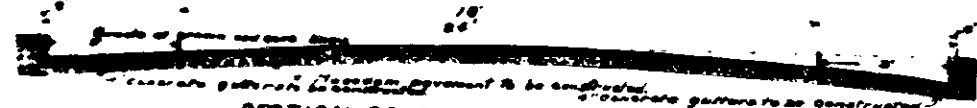

SECTION OF PAVEMENT A-A

Scale 1"=4'

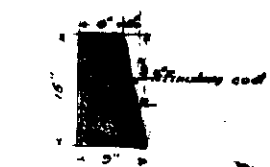

SECTION OF CURB

Scale 1"=1'

All elevations shown in this plan are based on the datum of mean sea level. The City Engineer is not responsible for the accuracy of the elevations shown in this plan.

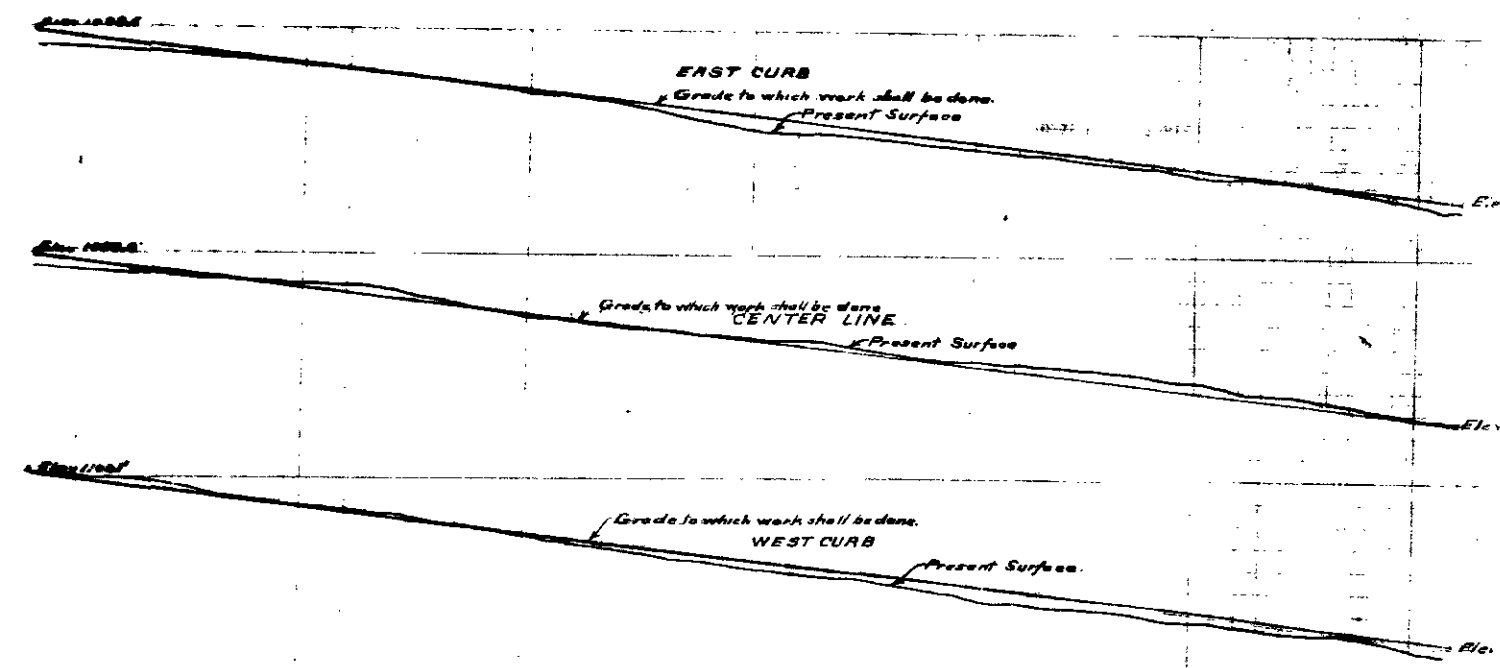

**PROFILE**  
BLACK LINES SHOW PRESENT SURFACE  
RED LINES SHOW GRADE TO WHICH WORK SHALL BE DONE